

MOTION CONTROL PRODUCTS

Mounting and Lubrication Instructions for Schmidt Inline Couplings

For Coupling Models: **L431C & L442C**

The Schmidt Inline Coupling will function properly if these mounting, maintenance and lubrication instructions are followed. Failure to observe these instructions may result in reduced coupling life.

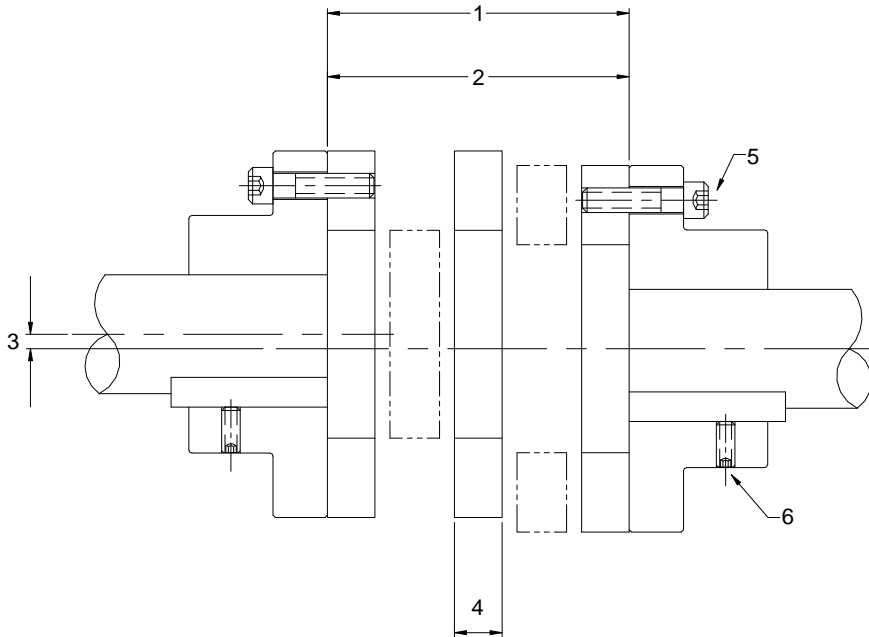

Mounting Instructions

It is important that the following assembly dimensions and tolerances are maintained before and during coupling operation.

Lubrication Instructions

The Schmidt Inline Coupling should be lubricated after the first 200 hours of operation, and again as specified by the lubrication schedule below.

RPM	Under 500	500 to 1000	Over 1000
Lube Cycle	Every 1000 Hours	Every 500 Hours	Every 200 Hours

Note: Always make certain that the lubrication fittings are clean before adding lubricant to prevent the introduction of foreign matter into the bearings. Use standard Alemite flush-type fitting Z-737.
Recommended Lubricant: Darina No. 2 (EP) Oil based grease

Position shafts and hubs according to the following values:

1. Hub faces to be parallel within:-----> .025 inch
 Speeds above 1000 rpm should be .015 inch or less.

Minimizing angular misalignment will allow the coupling bearings to achieve their maximum lifetime.

2. Distance between the hub faces:-----> 3.156 +/- .032 inch

3. Maximum shaft misalignment not to exceed:-----> 0.125 inch

The Schmidt Inline Coupling cannot operate properly at higher misalignments than listed. For speeds over 1000 rpm, maximum shaft displacement should not exceed 0.060".

4. Mount coupling between hubs. After installation of the coupling, check that the center disc is free to move laterally a small amount (approximately .015"- .025"). Remove handling bolt after coupling has been fixed to the hubs.

5. Tighten hub bolts to the end discs of the coupling.

6. Tighten setscrews in hub. If shock loads are expected, use two set screws per hub.



MOTION CONTROL PRODUCTS

Form S0431_01/21/08

Spare Parts for Schmidt Inline Couplings

Item Description	Item Number	Coupling Model Number	
		L431C	L442C
		Quantity Required Per Coupling	
Nylon Spacer-thick	S952600	8	8
Nylon Washer-thin	S952500	8	8
Retaining Ring	C132037	8	8
Needle Bearing	S500700	8	8
Link Assembly	S700840	4	4
Short Shaft	S853500	8	8

Repair Kits for Schmidt Inline Couplings

Standard repair kits are available for Schmidt Inline Couplings. Repair kits consist of needle bearings, spacers, washers, and retaining rings.

<u>Coupling Model</u>	<u>Repair Kit p/n</u>
L431C & L442C	S041700